

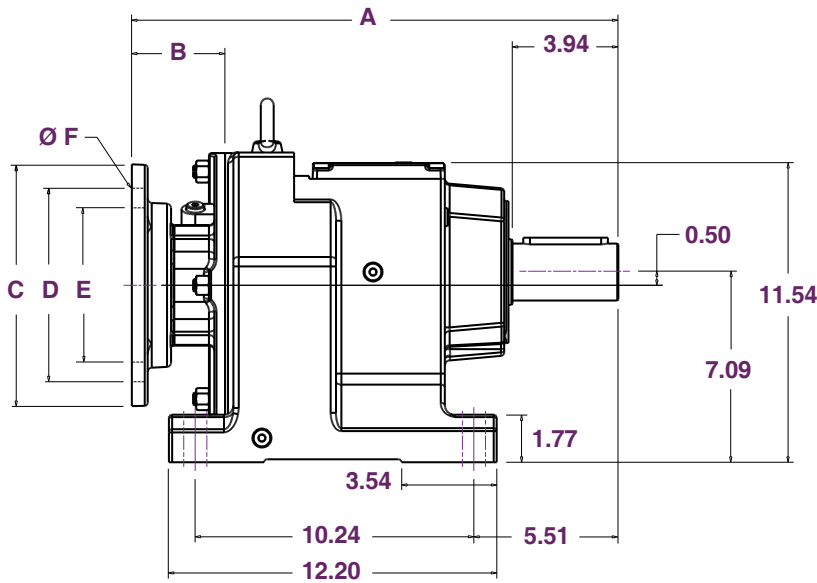

VR88 Dimensions

All dimensions listed in inches



Side

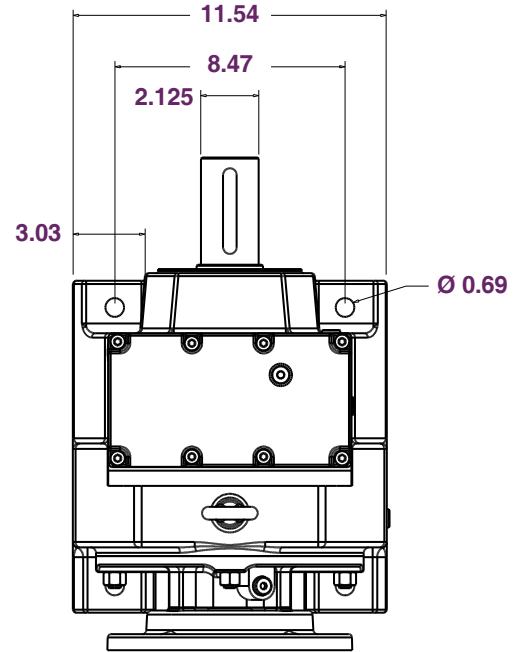

Top

Available Flanges:

Nema Flange Size	A (in)	B (in)	C (in)	D (in)	E (in)	F (in)
140TC	17.40	2.76	6.50	5.88	4.500	0.43
180TC	18.11	3.46	9.00	7.25	8.500	0.59
210TC	20.63	5.98	9.00	7.25	8.500	0.59
250TC	21.77	7.13	9.00	7.25	8.500	0.59
280TC	21.97	7.32	11.26	9.00	10.500	0.59

Specifications

Output Key Width (in)	Est. Oil* (oz)	Approx. Dry Reducer Weight* (lbs)
0.375	77.77	125.66

NOTE: *Oil estimation assumes standard mounting position "A". See page 55 for more information on specific oil amounts in various mounting positions.

*Reducer weights are approximate and can vary by several pounds depending on flange and ratio options.

Ø = common engineering symbol for "diameter".

Motor Options

Nema Frame	Motor Shaft Dia. (in)
56C	0.625
143TC	0.875
145TC	0.875
182TC	1.125
184TC	1.125
213TC	1.375
215TC	1.375

Efficiency

Reduction Stages	Efficiency (%)
2	96
3	94

VR88 Specifications

Stock VR88 Specifications:
Input Speed: 1750 RPM

Service Factor: 1.0

Nominal Ratio	Actual Ratio (:1)	Output Speed (RPM)	Input Power (HP)	Output Power (HP)	Output Torque (in-lbs)	Reduction Stages
60	60.35	29.00	6.71	6.31	13,718.6	3
50	47.58	36.78	8.51	8.01	13,718.6	3
40	41.74	41.93	9.70	9.13	13,718.6	3
30	27.84	62.86	14.25	13.68	13,718.6	2
25	23.40	74.79	16.95	16.28	13718.6	2
20	19.10	91.62	19.29	18.53	12,745.0	2
15	15.35	114.01	22.34	21.45	11,859.9	2

Special Order VR88 Specifications:
Input Speed: 1750 RPM

Service Factor: 1.0

Actual Ratio (:1)	Output Speed (RPM)	Input Power (HP)	Output Power (HP)	Output Torque (in-lbs)	Reduction Stages
246.54	7.10	1.64	1.55	13,718.6	3
216.54	8.08	1.87	1.76	13,718.6	3
205.71	8.51	1.97	1.85	13,718.6	3
181.77	9.63	2.23	2.10	13,718.6	3
155.34	11.27	2.61	2.45	13,718.6	3
142.41	12.29	2.84	2.67	13,718.6	3
124.97	14.00	3.24	3.05	13,718.6	3
118.43	14.78	3.42	3.22	13,718.6	3
103.65	16.88	3.90	3.68	13,718.6	3
93.38	18.74	4.33	4.08	13,718.6	3
81.92	21.36	4.94	4.65	13,718.6	3
72.57	24.11	5.58	5.25	13,718.6	3
63.68	27.48	6.36	5.98	13,718.6	3
52.82	33.13	7.66	7.21	13,718.6	3
41.74	41.93	9.70	9.13	13,718.6	3
36.84	47.50	10.99	10.34	13,718.6	3
34.40	50.87	11.16	10.72	13,276.1	2
32.66	53.58	12.39	11.66	13,718.6	3
31.40	55.73	12.63	12.13	13,718.6	2
23.40	74.79	16.95	16.28	13,718.6	2
21.51	81.36	17.84	17.14	13,276.1	2
17.08	102.46	20.82	20.00	12,302.5	2
13.33	131.28	24.57	23.60	11,328.9	2
11.93	146.69	26.38	25.34	10,886.4	2
9.90	176.77	30.50	29.29	10,443.8	2
9.14	191.47	33.88	32.53	10,709.3	2
8.22	212.90	36.11	34.68	10,266.8	2
7.13	245.44	38.40	36.88	9470.2	2
6.39	273.87	40.85	39.23	9027.7	2
5.30	330.19	43.94	42.20	8054.1	2

